

STEP 1:  
 APPLY NOVATAK TO ONE SIDE OF CORNER  
 WITH A MINIMUM OF 6" EXTENDING PAST  
 CORNER'S EDGE.  
 CUT FOLD AT BOTTOM OF SHEET AND TURN  
 VERTICAL SECTION AROUND CORNER AND  
 LEAVE HORIZONTAL LEG EXTENDED.

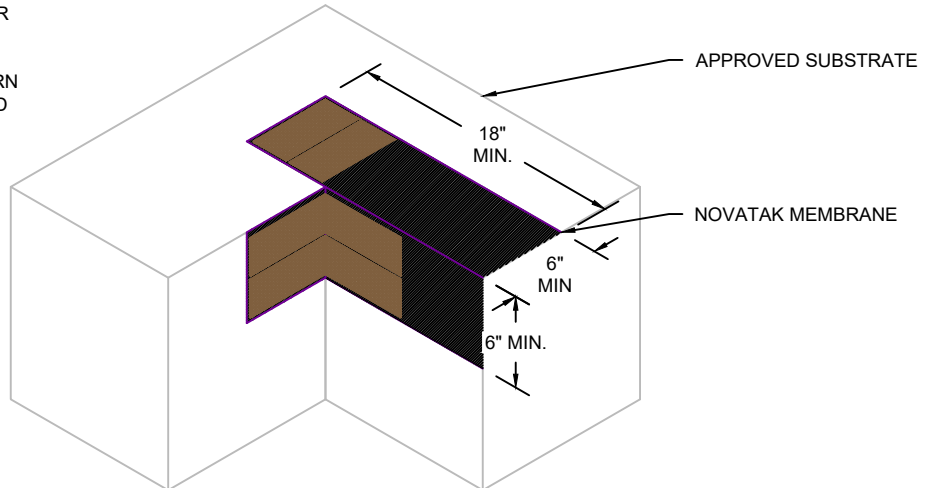

STEP 2:  
 APPLY NOVATAPE D TO  
 AREAS COVERED BY  
 SECOND SHEET

STEP 3:  
 APPLY SECOND NOVATAK SHEET TO  
 OPPOSITE SIDE OF CORNER WITH A  
 MINIMUM OF 6" EXTENDING PAST  
 CORNER'S EDGE.  
 CUT FOLD AT BOTTOM OF SHEET AND  
 TURN VERTICAL SECTION AROUND  
 CORNER TO OVERLAP FIRST SHEET AND  
 OVERLAP HORIZONTAL LEGS.

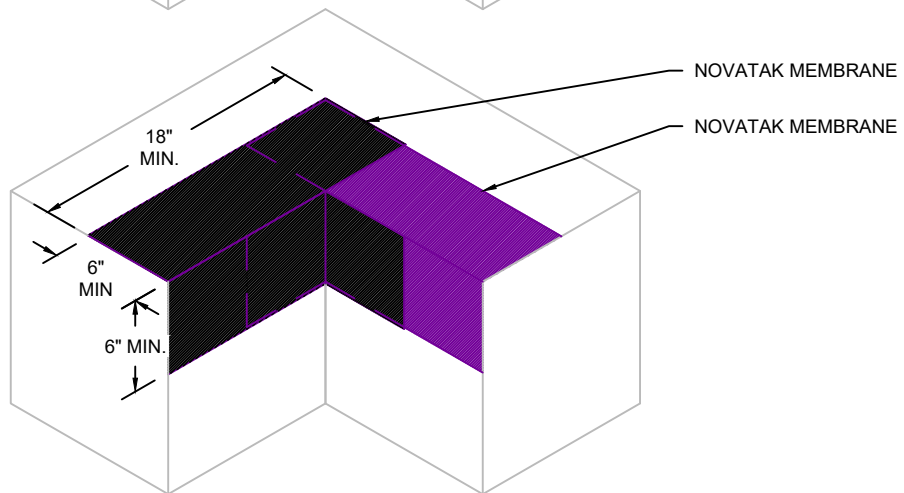

STEP 4:  
 REMOVE RELEASE LINER  
 FROM NOVATAPE D AND  
 ADHERE SECOND SHEET  
 TO FIRST SHEET

STEP 5:  
 APPLY BEAD OF E.STOP GU TO INSIDE  
 CORNER OF DETAIL

STEP 6:  
 APPLY NOVATAPE AT THE SEAM  
 BETWEEN THE TWO SHEETS

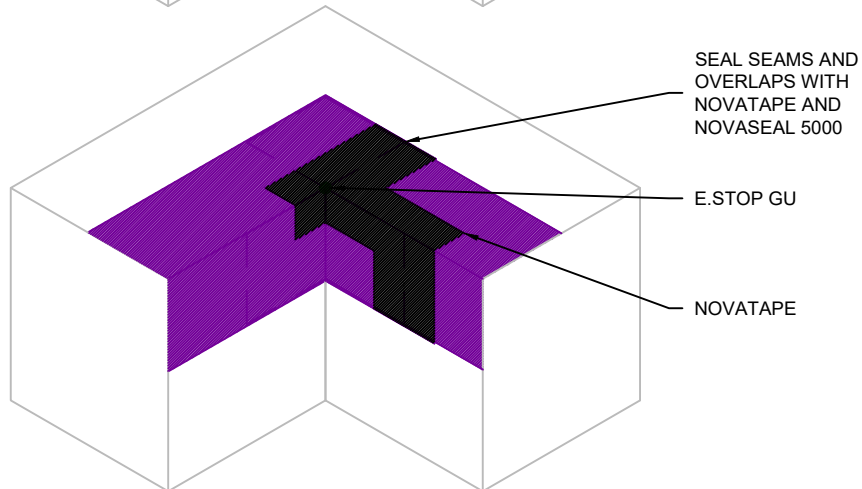

G:\My Drive\Epro Master Folder\Drafting\Details\Shoring\Novatak\50.381.4 CORNER - TOPSIDE - FIELD FORMED.dwg [Detail] July 01, 2021 - 10:05am

**CORNER - INSIDE - TOPSIDE - FIELD FORMED**



SYSTEM NAME	DRAWING NUMBER
NOVATAK	50.381.4
DRAFTER	DATE
RJT	5/06/2021

**NOVATAK**

AS A SUPPLIER OF FINISHED RPRODUCTS ONLY, EPRO SERVICES, INC. DOES NOT ASSUME RESPONSIBILITY FOR ERRORS IN DESIGN, ENGINEERING OR DIMENSIONS. THE PROJECT TEAM MUST VERIFY ALL DIMENSIONS AND SUITABILITY OF DETAILS. THE PRODUCTS LISTED ARE TRADEMARKS OF EPRO SERVICES, INC.

NTS

PAGE 1 OF 1