

STEP 1:
CUT A SQUARE PATCH OF
NOVATAK 8" WIDER THAN THE
WIDTH OF THE PENETRATION

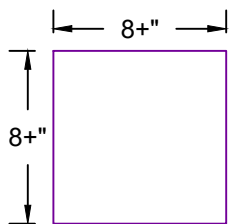

STEP 2:
FIND THE CENTER OF THE
SQUARE BY FOLDING IT
INTO QUARTERS

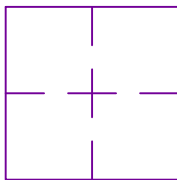

STEP 3:
STAR-CUT CENTER OF
SQUARE TO THE WIDTH
OF THE PENETRATION (TRIM
FLANGES TO 2" MAX. LENGTH)

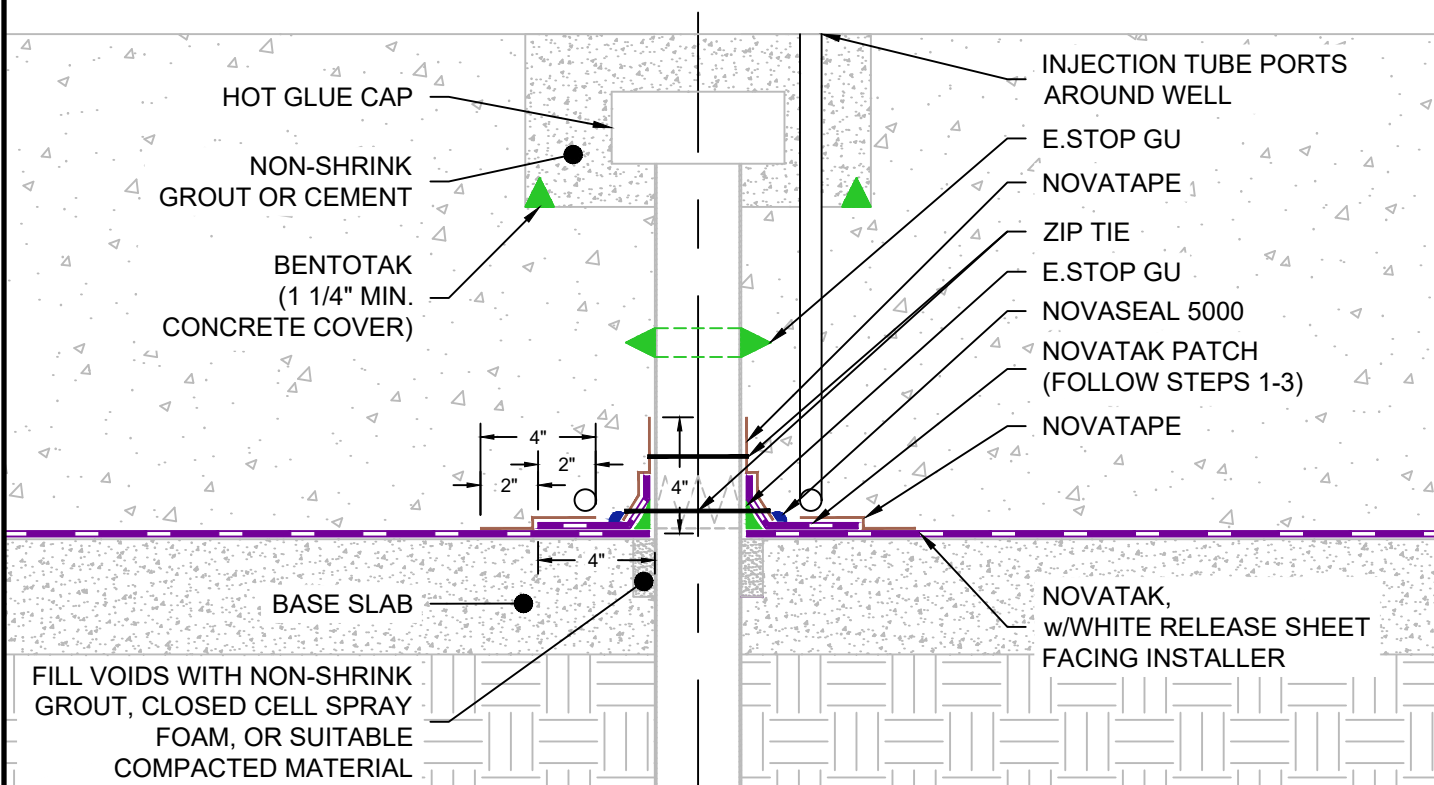
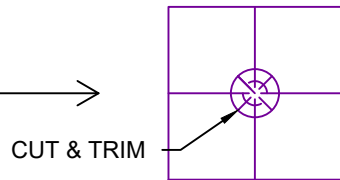

DEWATERING PIPE CAP APPLICATION STEPS:

- 1) BLOCKOUT OR SAW CUT A SQUARE OPENING A MINIMUM OF 6" FROM THE OUTSIDE OF THE PIPE
-IF SAW CUT, BREAKOUT CONCRETE AROUND PIPE
- 2) CUT PIPE A MINIMUM OF 4" DOWN BELOW TOP OF SLAB
- 3) FILL BOTTOM OF PIPE WITH BENTONITE SLURRY PER BUILDING CODE
- 4) FILL PIPE WITH NON-SHRINK GROUT - EXTEND FROM TOP OF WELL TO 12" BELOW UNDERSLAB SYSTEM
- 5) APPLY HOT GLUE CAP ON PIPE
- 6) APPLY BENTOTAK WATERSTOP AROUND THE INNER PERIMETER OF BLOCKOUT/SAW CUT AREA
- 7) FILL BLOCKOUT/SAW CUT AREA WITH NON-SHRINK GROUT OR CEMENT

NOTES:

- 1) NOVATAK MEMBRANE BOOT MUST BE FIT SNUG AROUND PIPE WITHOUT FOLDING OR FALLING DOWN. NOVATAPE MUST BE USED TO COMPLETELY SEAL BETWEEN BOOT AND PIPE, TIGHTEN HOSE CLAMP AS TIGHT AS POSSIBLE WITHOUT DAMAGING THE MEMBRANE
- 2) SPACE PENETRATIONS A MINIMUM OF 6" FROM SLAB EDGE, CORNERS, WALLS, OR OTHER PENETRATIONS.

G:\My Drive\Epro Master Folder\Drafting\Details\Underslab\Novatak\50.127.1 UNDERSLAB PENETRATION - DEWATERING PIPE.dwg [Detail] July 01, 2021 - 8:39am

UNDERSLAB PENETRATION - DEWATERING PIPE

	SYSTEM NAME	DRAWING NUMBER	
	NOVATAK	50.127.1	
	DRAFTER	DATE	
	RJT	6/30/2021	

AS A SUPPLIER OF FINISHED PRODUCTS ONLY, EPRO SERVICES, INC. DOES NOT ASSUME RESPONSIBILITY FOR ERRORS IN DESIGN, ENGINEERING OR DIMENSIONS. THE PROJECT TEAM MUST VERIFY ALL DIMENSIONS AND SUITABILITY OF DETAILS. THE PRODUCTS LISTED ARE TRADEMARKS OF EPRO SERVICES, INC.

NTS

PAGE 1 OF 1